

CROFT, LLC

SERIES 96 SINGLE HUNG WINDOW



P.O. BOX 826
MCCOMB, MS 39649
PH: 601-684-6121 FX: 601-783-3188

INSTALLATION NOTES:

1. **ONE (1)** INSTALLATION ANCHOR IS REQUIRED AT EACH ANCHOR LOCATION SHOWN, UNLESS OTHERWISE STATED.
2. THE NUMBER OF INSTALLATION ANCHORS DEPICTED IS THE MINIMUM NUMBER OF ANCHORS TO BE USED FOR PRODUCT INSTALLATION.
3. INSTALL INDIVIDUAL INSTALLATION ANCHORS WITHIN A TOLERANCE OF ±1/2 INCH OF THE DEPICTED LOCATION IN THE ANCHOR LAYOUT DETAIL (I.E., WITHOUT CONSIDERATION OF TOLERANCES). TOLERANCES ARE NOT CUMULATIVE FROM ONE INSTALLATION ANCHOR TO THE NEXT.
4. **36" X 72" UNIT:** FOR INSTALLATION INTO 2X WOOD BUCK, USE #8 WOOD SCREWS OF SUFFICIENT LENGTH TO ACHIEVE 1 1/2 INCH MINIMUM EMBEDMENT INTO WOOD SUBSTRATE.
5. **FIN/FLANGE FRAMES:** FOR INSTALLATION INTO 2X WOOD BUCK, USE #10 WOOD SCREWS OF SUFFICIENT LENGTH TO ACHIEVE 1 1/2 INCH MINIMUM EMBEDMENT INTO WOOD SUBSTRATE.
6. **FLANGE FRAMES:** FOR INSTALLATION THROUGH 1X BUCK TO CONCRETE/MASONRY, OR DIRECTLY INTO CONCRETE/ MASONRY, USE ONE (1) 3/16 INCH ITW TAPCON PER INSTALLATION CLIP OF SUFFICIENT LENGTH TO ACHIEVE 1 1/4 INCH MINIMUM EMBEDMENT INTO CONCRETE/MASONRY SUBSTRATE.
7. **FIN/FLANGE FRAMES:** FOR INSTALLATION THROUGH STEEL STUD USE #10 SELF-TAPPING SCREWS OF SUFFICIENT LENGTH TO ACHIEVE 3 THREADS MINIMUM PENETRATION BEYOND STEEL STRUCTURE.
7. MINIMUM EMBEDMENT AND EDGE DISTANCE EXCLUDE WALL FINISHES, INCLUDING BUT NOT LIMITED TO STUCCO, FOAM, BRICK VENEER, AND SIDING.
8. INSTALLATION ANCHORS AND ASSOCIATED HARDWARE MUST BE MADE OF CORROSION RESISTANT MATERIAL OR HAVE A CORROSION RESISTANT COATING.
9. FOR HOLLOW BLOCK AND GROUT FILLED BLOCK, DO NOT INSTALL INSTALLATION ANCHORS INTO MORTAR JOINTS. EDGE DISTANCE IS MEASURED FROM FREE EDGE OF BLOCK OR EDGE OF MORTAR JOINT INTO FACE SHELL OF BLOCK.
10. INSTALLATION ANCHORS SHALL BE INSTALLED IN ACCORDANCE WITH ANCHOR MANUFACTURER'S INSTALLATION INSTRUCTIONS, AND ANCHORS SHALL NOT BE USED IN SUBSTRATES WITH STRENGTHS LESS THAN THE MINIMUM STRENGTH SPECIFIED BY THE ANCHOR MANUFACTURER.
11. INSTALLATION ANCHOR CAPACITIES FOR PRODUCTS HEREIN ARE BASED ON SUBSTRATE MATERIALS WITH THE FOLLOWING PROPERTIES:
 - A. WOOD - MINIMUM SPECIFIC GRAVITY OF 0.55.
 - B. CONCRETE -MINIMUM COMPRESSIVE STRENGTH OF 3192 PSI.
 - C. MASONRY - STRENGTH CONFORMANCE TO ASTM C-90.
 - D. STEEL - MINIMUM YIELD STRENGTH OF 33 KSI. MINIMUM WALL THICKNESS OF 33 MILS. (20 GAUGE)

GENERAL NOTES:

1. THE PRODUCT SHOWN HEREIN IS DESIGNED AND MANUFACTURED TO COMPLY WITH THE 5TH EDITION 2014 FLORIDA BUILDING CODE (FBC) EXCLUDING HVHZ AND HAS BEEN EVALUATED ACCORDING TO THE FOLLOWING:
 - AAMA/WDMA/CSA 101/I.S.2/A440-08
2. ADEQUACY OF THE EXISTING STRUCTURAL CONCRETE/MASONRY, 2X AND METAL STUD FRAMING AS A MAIN WIND FORCE RESISTING SYSTEM CAPABLE OF WITHSTANDING AND TRANSFERRING APPLIED PRODUCT LOADS TO THE FOUNDATION IS THE RESPONSIBILITY OF THE ENGINEER OR ARCHITECT OF RECORD FOR THE PROJECT OF INSTALLATION.
3. 1X AND 2X BUCKS (WHEN USED) SHALL BE DESIGNED AND ANCHORED TO PROPERLY TRANSFER ALL LOADS TO THE STRUCTURE. BUCK DESIGN AND INSTALLATION IS THE RESPONSIBILITY OF THE ENGINEER OR ARCHITECT OF RECORD FOR THE PROJECT OF INSTALLATION.
4. THE INSTALLATION DETAILS DESCRIBED HEREIN ARE GENERIC AND MAY NOT REFLECT ACTUAL CONDITIONS FOR A SPECIFIC SITE. IF SITE CONDITIONS CAUSE INSTALLATION TO DEVIATE FROM THE REQUIREMENTS DETAILED HEREIN, A LICENSED ENGINEER OR ARCHITECT SHALL PREPARE SITE SPECIFIC DOCUMENTS FOR USE WITH THIS DOCUMENT.
5. APPROVED IMPACT PROTECTIVE SYSTEM IS REQUIRED TO PROTECT THIS PRODUCT IN AREAS REQUIRING IMPACT RESISTANCE.
6. WINDOW FRAME MATERIAL: 6063-T5 ALUMINUM
7. GLASS SHALL MEET REQUIREMENTS OF ASTM E1300-04 GLASS CHARTS. SEE SHEET 4 FOR GLAZING DETAILS..
8. DESIGNATIONS "X" AND "O" STAND FOR THE FOLLOWING:
X: OPERABLE PANEL
O: FIXED PANEL

TABLE OF CONTENTS		
SHEET	REVISION	SHEET DESCRIPTION
1	A	GENERAL & INSTALLATION NOTES
2	-	ELEVATIONS & ANCHOR LAYOUTS
3	-	INSTALLATION DETAILS - FLANGE FRAME
4	-	GLAZING & INSTALLATION DETAILS - FIN FRAME
5	-	COMPONENTS & BILL OF MATERIALS

FRAME TYPE	OVERALL SIZE		DP RATING	MISSILE IMPACT RATING
	WIDTH	HEIGHT		
FLANGE	52"	76"	+/- 35 PSF	NON-IMPACT
FIN	48"	72"	+/- 35 PSF	NON-IMPACT
	36"	72"	+/- 40 PSF	NON-IMPACT

TITLE: SERIES 96 SINGLE-HUNG GENERAL & INSTALLATION NOTES	PREPARED BY: BUILDING DROPS, INC. 398 E. DANIA BEACH BLVD., #338 DANIA BEACH, FL 33004 PH: (954) 399-8478 FX: (954) 744-4738								
REVISIONS	<table border="1" style="width: 100%; border-collapse: collapse;"> <thead> <tr> <th style="width: 10%;">NO.</th> <th style="width: 70%;">DESCRIPTION</th> <th style="width: 10%;">BY</th> <th style="width: 10%;">DATE</th> </tr> </thead> <tbody> <tr> <td style="text-align: center;">1</td> <td>5TH EDITION 2014 FBC REVISION</td> <td style="text-align: center;">LS</td> <td style="text-align: center;">02/11/16</td> </tr> </tbody> </table>	NO.	DESCRIPTION	BY	DATE	1	5TH EDITION 2014 FBC REVISION	LS	02/11/16
NO.	DESCRIPTION	BY	DATE						
1	5TH EDITION 2014 FBC REVISION	LS	02/11/16						

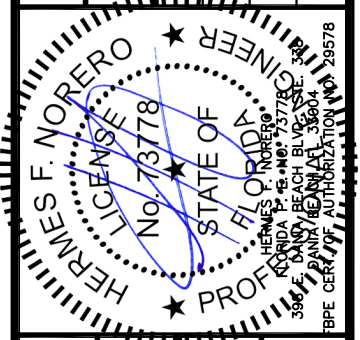

DATE: 08.08.13	DWN BY: MSS	CHK BY: HFN	SCALE: NTS
DWG #: CRF014			
SHEET: 1 OF 5			

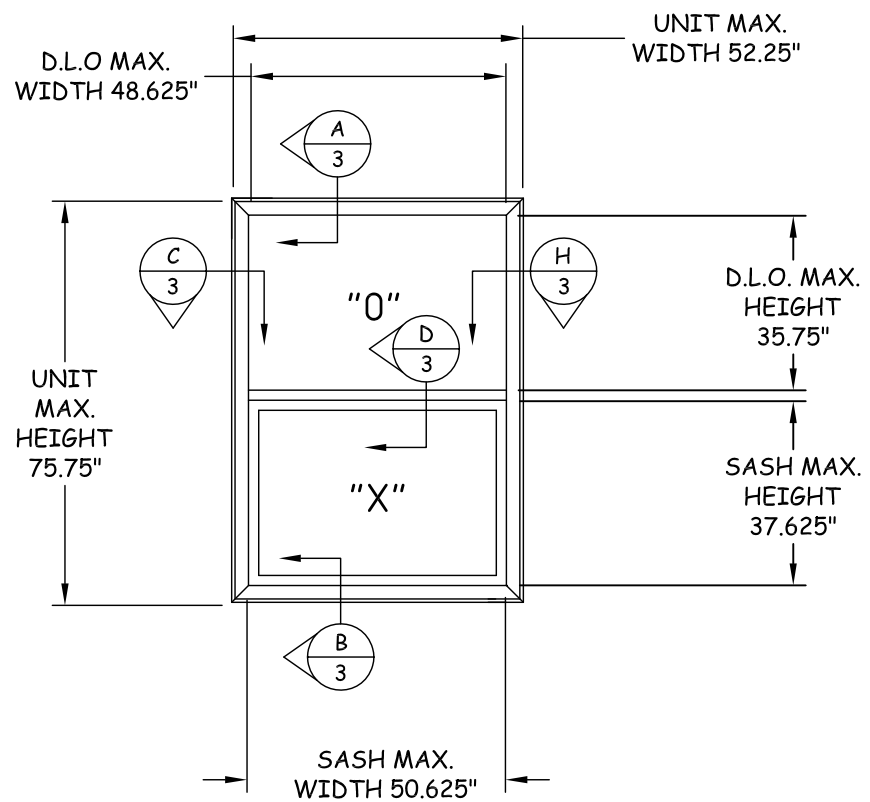

ELEVATION
FLANGE FRAME

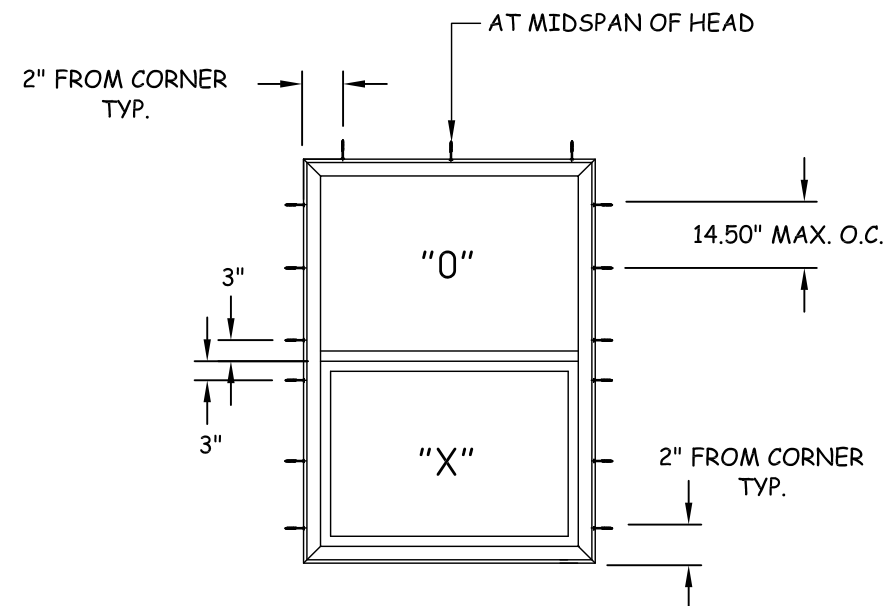

ANCHOR LAYOUT
FLANGE FRAME

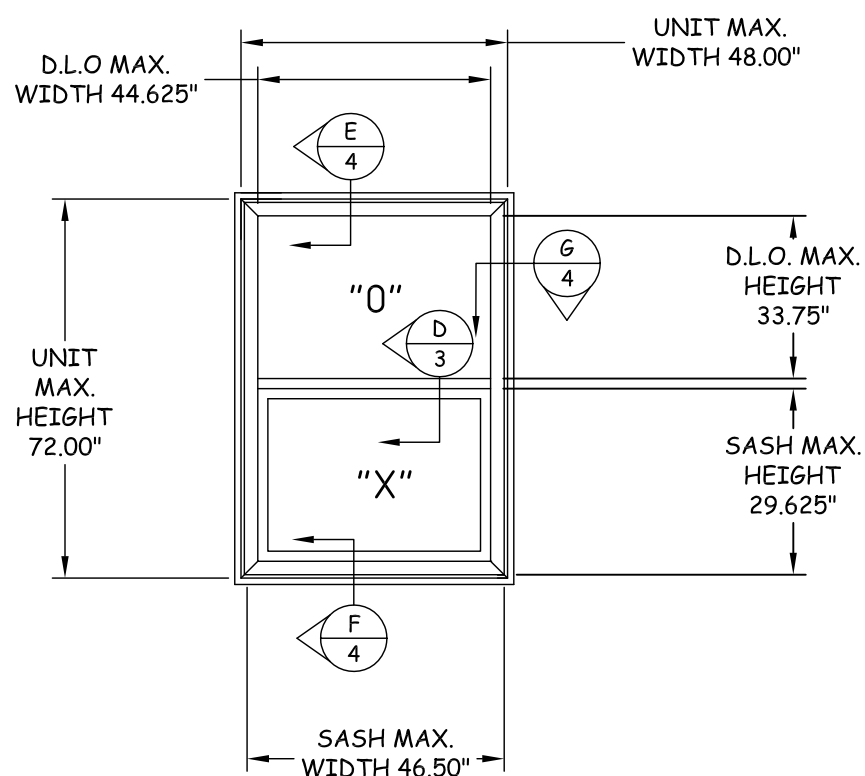

ELEVATION
FIN FRAME
48\"/>

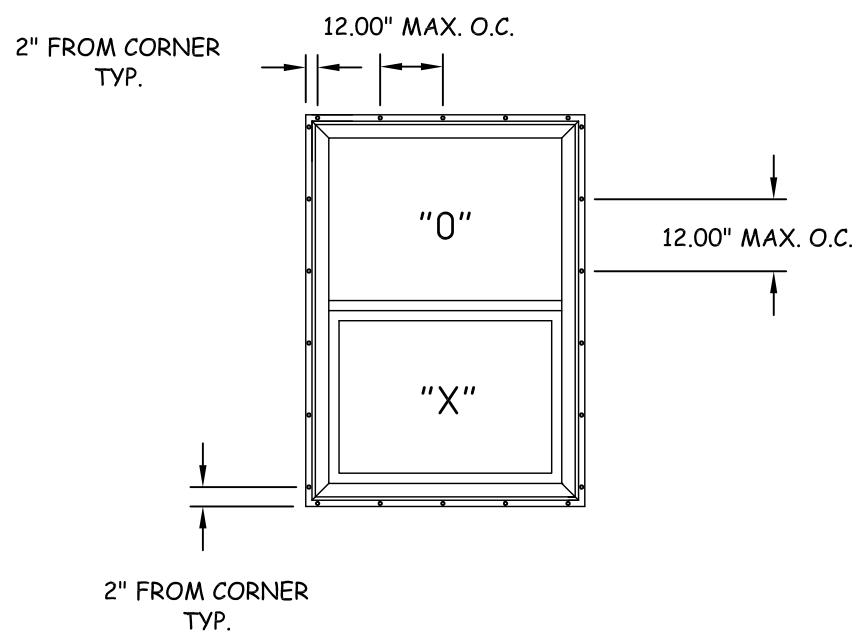

ANCHOR LAYOUT
FIN FRAME
48\"/>

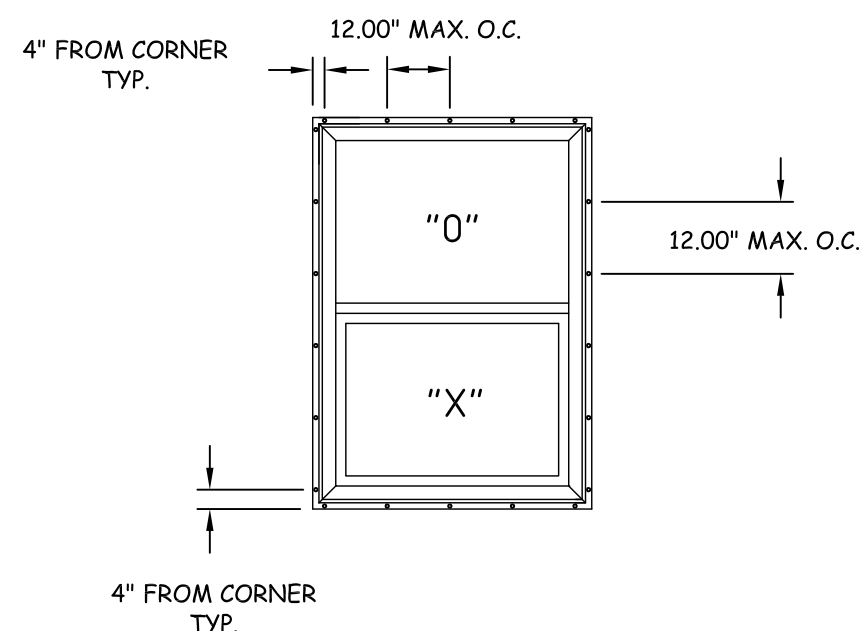

ANCHOR LAYOUT
FIN FRAME
36\"/>

TITLE: SERIES 96 SINGLE-HUNG ELEVATIONS & ANCHOR LAYOUTS
PREPARED BY: BUILDING DROPS, INC. 398 E. DANIA BEACH BLVD., #338 DANIA BEACH, FL 33004
PH: (954) 399-8478 FX: (954) 744-4738

NO.	DESCRIPTION	BY	DATE

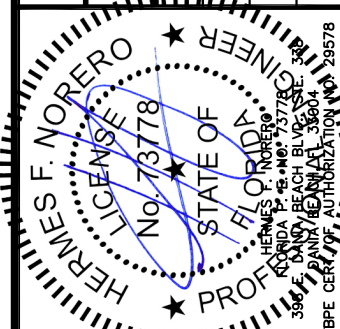

DATE: 08.08.13
DWN BY: MSS
CHK BY: HFN
SCALE: NTS

DWG #: **CRF014**
SHEET: **2 OF 5**

TITLE: SERIES 96 SINGLE-HUNG
INSTALLATION DETAILS - FLANGE
FRAME

PREPARED BY:
BUILDING DROPS, INC.
398 E. DANIA BEACH BLVD., #338
DANIA BEACH, FL 33004
PH: (954) 399-8478 FX: (954) 744-4738

REVISIONS	DESCRIPTION	BY	DATE

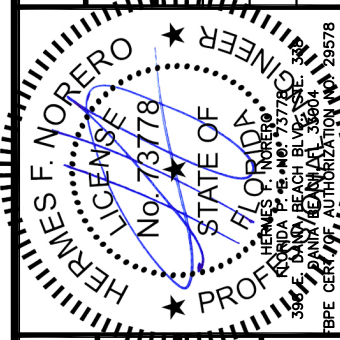

DATE:	08.08.13
DWN BY:	MSS
CHK BY:	HFN
SCALE:	NTS

DWG #: **CRF014**
SHEET: **3 OF 5**

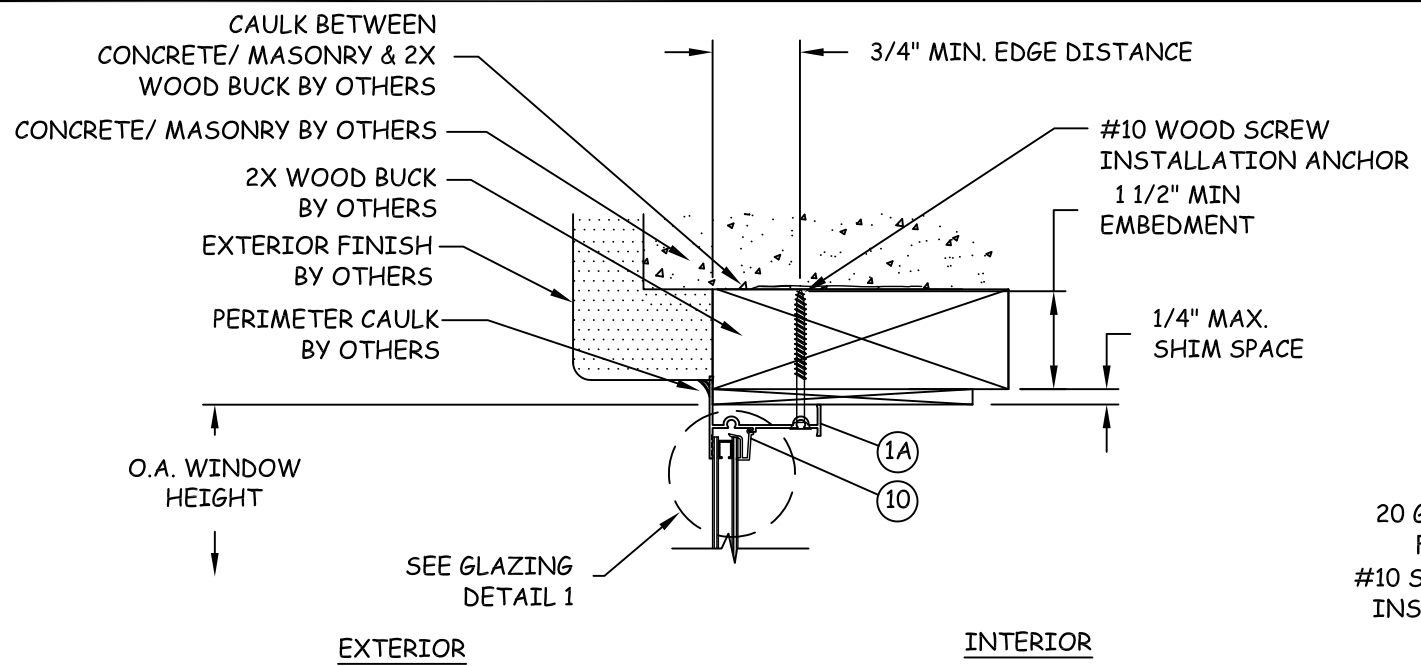

A
3 VERTICAL SECTION
HEAD - 2X WOOD BUCK
FLANGE FRAME

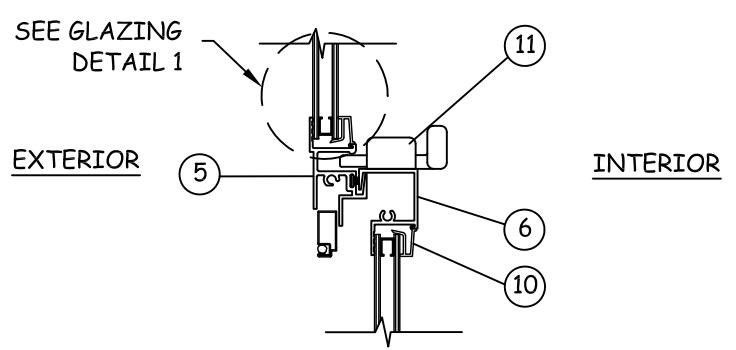

D
3 VERTICAL SECTION
MEETING RAIL

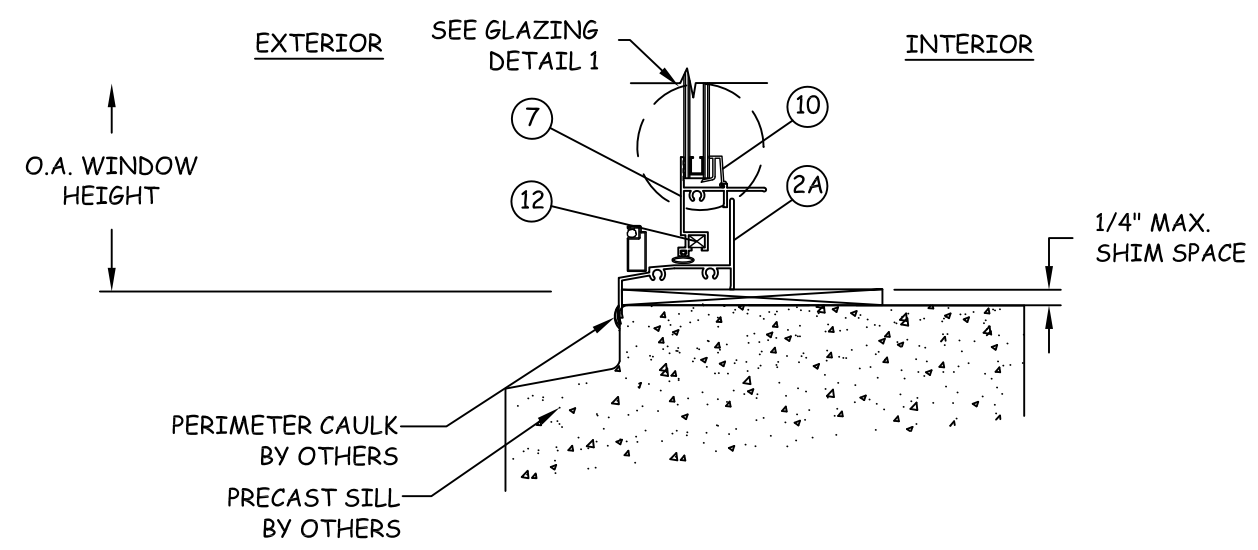

B
3 VERTICAL SECTION
SILL - PRECAST CONCRETE
FLANGE FRAME

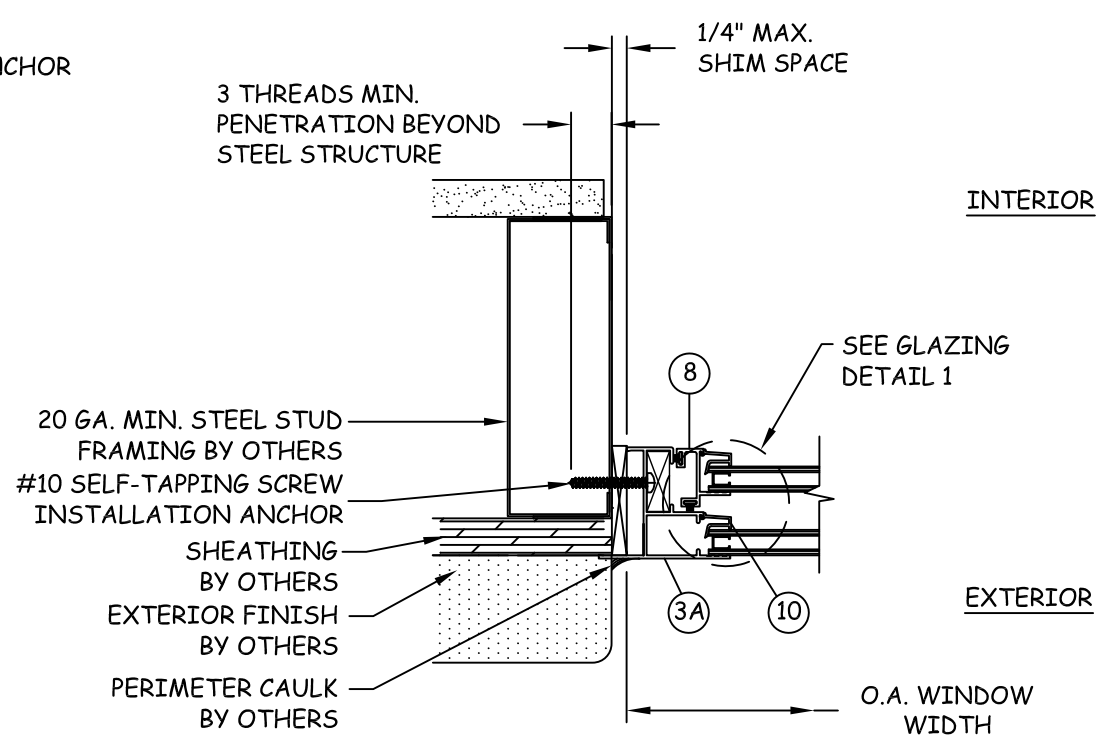

C
3 HORIZONTAL SECTION
JAMB - STEEL STUD FRAME
FLANGE FRAME

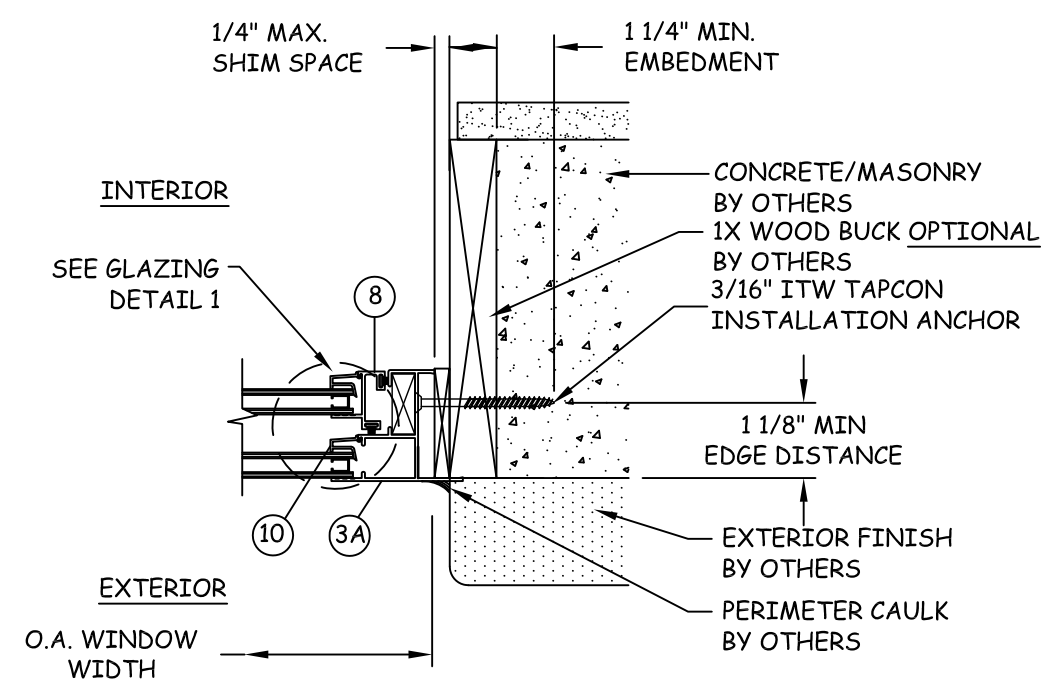

H
3 HORIZONTAL SECTION
JAMB - 1X BUCK/CONCRETE/MASONRY
FLANGE FRAME

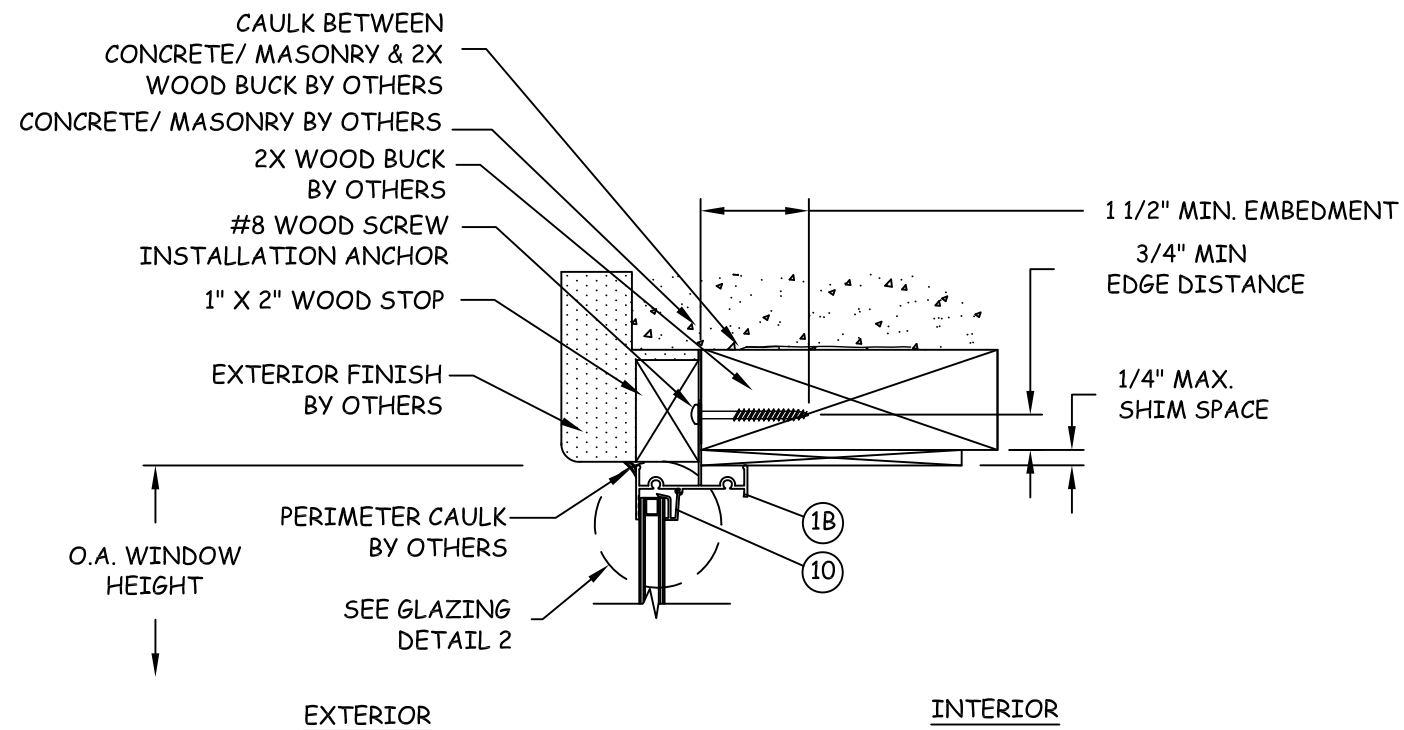

E
4 **VERTICAL SECTION**
HEAD - 2X WOOD BUCK
FIN FRAME - 36" X 72" UNIT

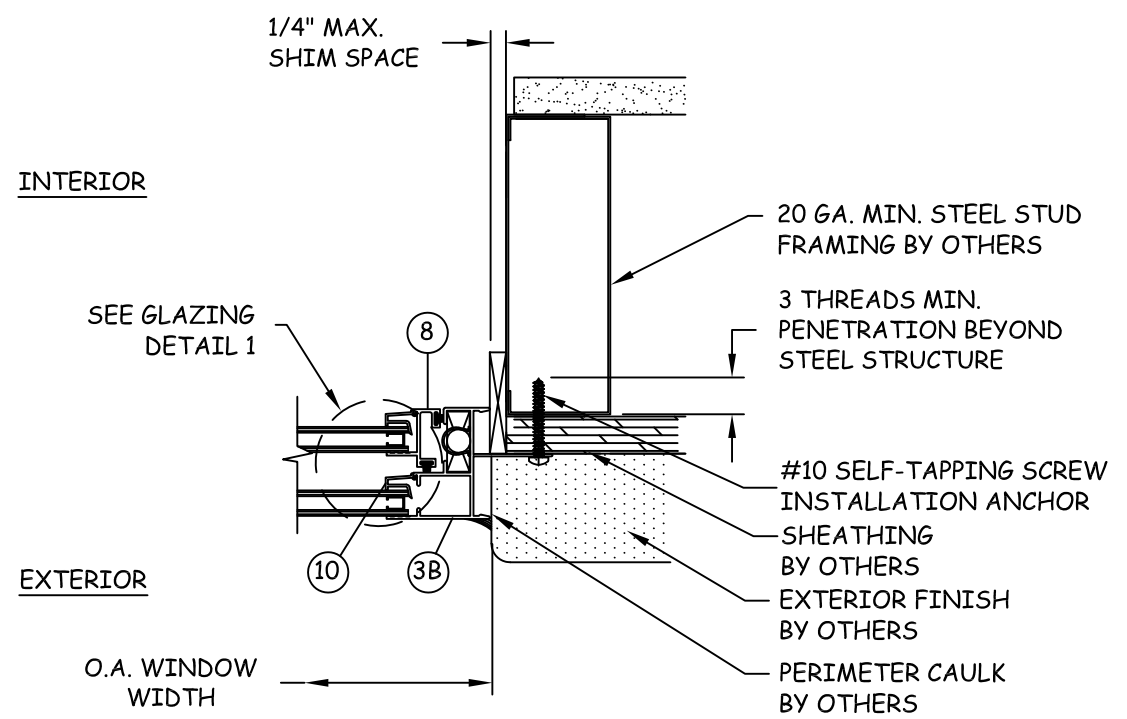

G
4 **HORIZONTAL SECTION**
JAMB - STEEL STUD FRAME
FIN FRAME - 48" X 72" UNIT

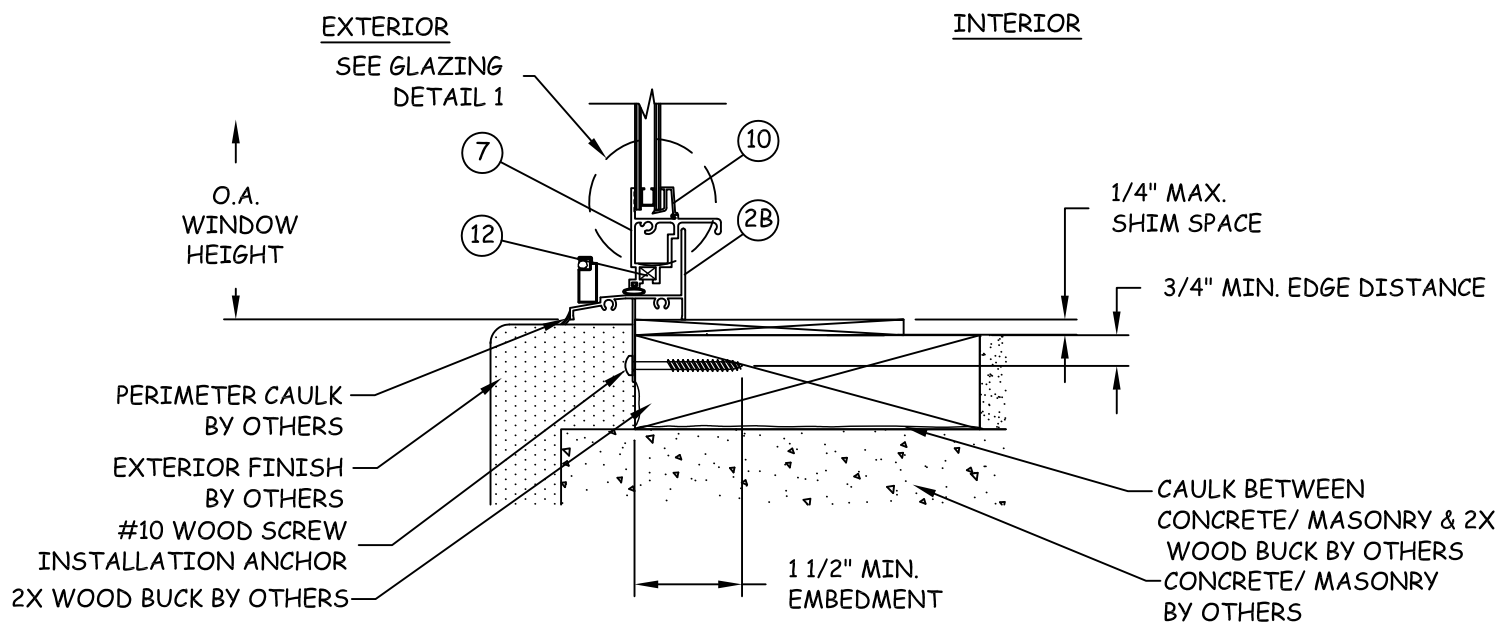

F
4 **VERTICAL SECTION**
SILL - 2X WOOD BUCK
FIN FRAME - 48" X 72" UNIT

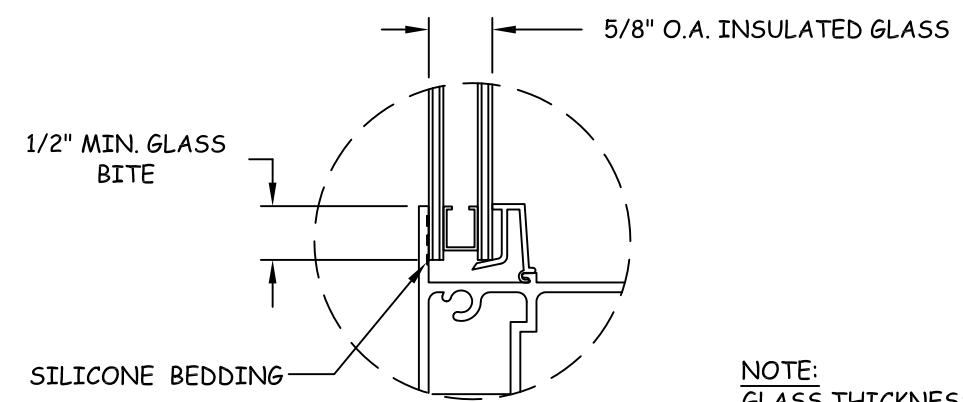

GLAZING DETAIL 1

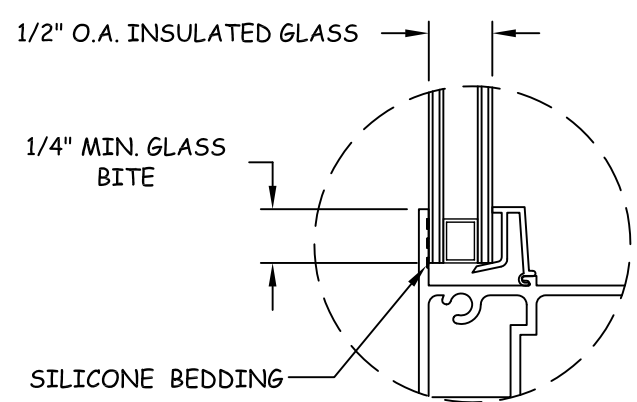

GLAZING DETAIL 2

NOTE:
GLASS THICKNESS AND TYPE
MAY VARY PER ASTM E 1300-04
GLASS CHART REQUIREMENTS
AND REQUIREMENTS SET FORTH
IN THE CURRENT FLORIDA
BUILDING CODE.

TITLE: SERIES 96 SINGLE-HUNG
GLAZING & INSTALLATION DETAILS -
FIN FRAME

PREPARED BY:
BUILDING DROPS, INC.
398 E. DANIA BEACH BLVD., #338
DANIA BEACH, FL 33004
PH: (954) 399-8478 FX: (954) 744-4738

NO.	DESCRIPTION	BY	DATE

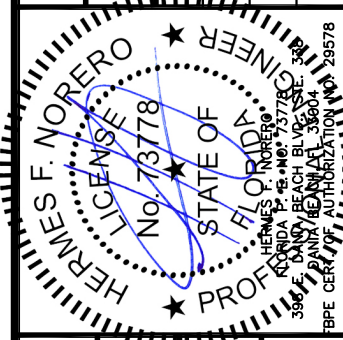

DATE: 08.08.13	DWN BY: MSS	CHK BY: HFN	SCALE: NTS
-------------------	----------------	----------------	---------------

DWG #:
CRF014

SHEET: **4 OF 5**

BILL OF MATERIAL

ITEM #	DESCRIPTION	MATERIAL	MANUFACTURER
1A	FRAME HEAD - FLANGE	6063-T5 ALUMINUM	CROFT, LLC
1B	FRAME HEAD - FIN	6063-T5 ALUMINUM	CROFT, LLC
2A	FRAME SILL - FLANGE	6063-T5 ALUMINUM	CROFT, LLC
2B	FRAME SILL - FIN	6063-T5 ALUMINUM	CROFT, LLC
3A	FRAME JAMB (LH) - FLANGE	6063-T5 ALUMINUM	CROFT, LLC
3B	FRAME JAMB (LH) - FIN	6063-T5 ALUMINUM	CROFT, LLC
4A	FRAME JAMB (RH) - FLANGE	6063-T5 ALUMINUM	CROFT, LLC
4B	FRAME JAMB (RH) - FIN	6063-T5 ALUMINUM	CROFT, LLC
5	MEETING RAIL	6063-T5 ALUMINUM	CROFT, LLC
6	VENT HEAD	6063-T5 ALUMINUM	CROFT, LLC
7	VENT SILL	6063-T5 ALUMINUM	CROFT, LLC
8	VENT JAMB	6063-T5 ALUMINUM	CROFT, LLC
9	VENT STOP	6063-T5 ALUMINUM	CROFT, LLC
10	GLAZING BEAD	RIGID PVC	CROFT, LLC
11	CAM LOCK	-	CROFT, LLC
12	PIVOT BAR	-	CROFT, LLC
13	BALANCE ASSEMBLY	-	CROFT, LLC
14	VINYL SEAL	-	CROFT, LLC
15	WOOLPILE	-	CROFT, LLC

1A FRAME HEAD - FLANGE
6063-T5 AL.
TYPICAL WALL THICKNESS: .050"

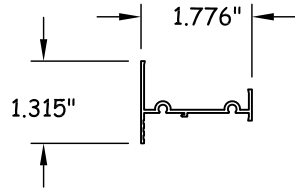

1B FRAME HEAD - FIN
6063-T5 AL.
TYPICAL WALL THICKNESS: .050"

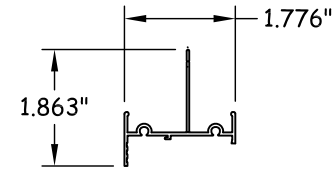

2A FRAME SILL - FLANGE
6063-T5 AL.
TYPICAL WALL THICKNESS: .050"

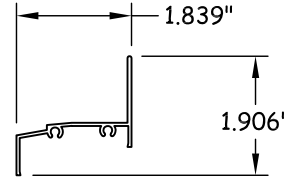

2B FRAME SILL - FIN
6063-T5 AL.
TYPICAL WALL THICKNESS: .050"

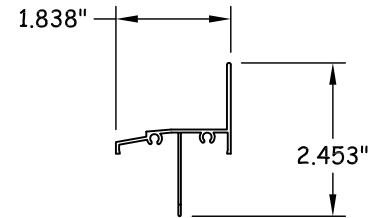

3A **4A** FRAME JAMB (LH/RH) - FLANGE
6063-T5 AL.
TYPICAL WALL THICKNESS: .050"

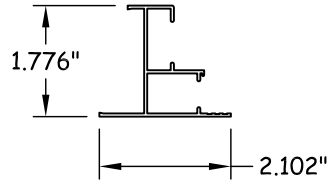

3B FRAME JAMB (LH) - FIN
6063-T5 AL.
TYPICAL WALL THICKNESS: .050"

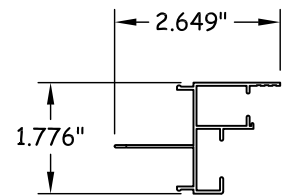

4B FRAME JAMB (RH) - FIN
6063-T5 AL.
TYPICAL WALL THICKNESS: .050"

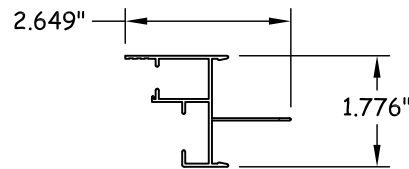

5 MEETING RAIL
6063-T5 AL.
TYPICAL WALL THICKNESS: .050"

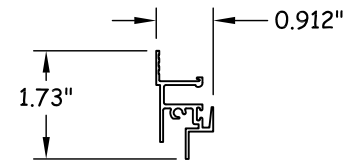

6 VENT HEAD
6063-T5 AL.
TYPICAL WALL THICKNESS: .050"

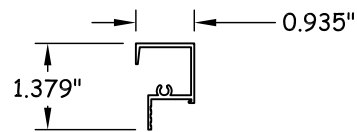

7 VENT SILL
6063-T5 AL.
TYPICAL WALL THICKNESS: .050"

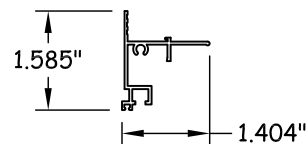

8 VENT JAMB
6063-T5 AL.
TYPICAL WALL THICKNESS: .050"

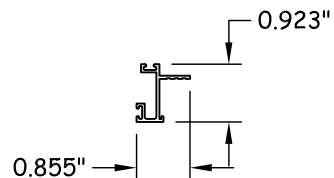

10 GLAZING BEAD
RIGID PVC

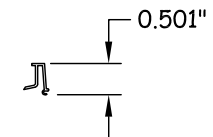

Est. 1920
CROFT
P.O. BOX 826
MCCOMB, MS 39649
PH: 601-684-6121 FX: 601-783-3188

TITLE: SERIES 96 SINGLE-HUNG COMPONENTS & BILL OF MATERIALS
PREPARED BY: BUILDING DROPS, INC.
398 E. DANIA BEACH BLVD., #338
DANIA BEACH, FL 33004
PH: (954) 399-8478 FX: (954) 744-4738

REVISIONS	DESCRIPTION	NO.	BY	DATE

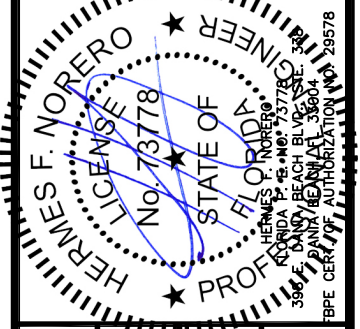

DATE: 08.08.13
DWN BY: MSS
CHK BY: HFN
SCALE: NTS

DWG #: **CRF014**
SHEET: **5 OF 5**